

Half Clips KMC

Hot Dipped Galvanized Steel, Chem-Treated G90 Finish, per ASTM A653/A653M, 1/32" Thick Black Vinyl Cushion

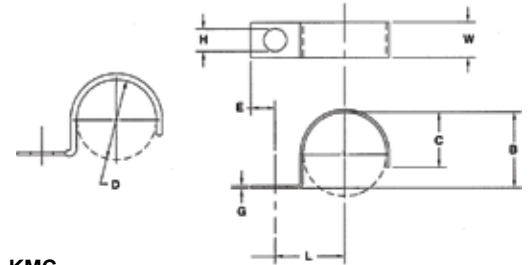

Half clips are used primarily for holding wires, tubing, conduit, or pipe against a solid backing surface. For this purpose it is excellent and easy to assemble.



| D | H | L | E | B | C | G | W | | | | |
|----------------------------|--------------------|---------------------------|-----------------------------|---------------------------------|------------------|---------------|----------------|-----------------|-------------|-------------------|----------|
| Clamping Diameter ±.031 | Hole Dia. ±.005 | Center To Center ±.031 | Hole Center To End ±.015 | Base To Top Of Dia. ±.015 | Closure ±.015 | Gage ±.002 | Width ±.020 | KMC Part Number | Part Number | Lbs. Per 100 Pcs. | Quantity |
| 0.187 | 0.218 | 0.437 | 0.250 | 0.188 | 0.156 | 0.032 | 0.500 | CHV-0407Z1 | 2021785 | 0.48 | 100 |
| | 0.281 | 0.437 | 0.250 | 0.188 | 0.156 | 0.032 | 0.500 | CHV-0409Z1 | 2021786 | 0.50 | 100 |
| 0.250 | 0.218 | 0.500 | 0.250 | 0.250 | 0.188 | 0.048 | 0.500 | CHV-0507Z1 | 2021787 | 0.85 | 100 |
| | 0.281 | 0.500 | 0.250 | 0.250 | 0.188 | 0.048 | 0.500 | CHV-0509Z1 | 2021788 | 0.81 | 100 |
| | 0.343 | 0.500 | 0.250 | 0.250 | 0.188 | 0.048 | 0.625 | CHV-0511Z1 | 2021789 | 1.00 | 100 |
| 0.312 | 0.218 | 0.531 | 0.312 | 0.312 | 0.218 | 0.048 | 0.625 | CHV-0607Z1 | 2021790 | 1.25 | 100 |
| | 0.281 | 0.531 | 0.312 | 0.312 | 0.218 | 0.048 | 0.625 | CHV-0609Z1 | 1857494 | 1.22 | 100 |
| | 0.343 | 0.687 | 0.343 | 0.375 | 0.218 | 0.060 | 0.625 | CHV-0611Z1 | 2021791 | 2.00 | 100 |
| | 0.406 | 0.687 | 0.343 | 0.375 | 0.218 | 0.060 | 0.750 | CHV-0613Z1 | 2021792 | 2.05 | 100 |
| 0.375 | 0.218 | 0.562 | 0.312 | 0.375 | 0.281 | 0.048 | 0.625 | CHV-0707Z1 | 2021793 | 1.39 | 100 |
| | 0.281 | 0.562 | 0.312 | 0.375 | 0.281 | 0.048 | 0.625 | CHV-0709Z1 | 2021794 | 1.35 | 100 |
| | 0.343 | 0.687 | 0.375 | 0.375 | 0.281 | 0.060 | 0.625 | CHV-0711Z1 | 2021795 | 1.79 | 100 |
| | 0.406 | 0.687 | 0.375 | 0.375 | 0.281 | 0.060 | 0.750 | CHV-0713Z1 | 1857500 | 2.28 | 100 |
| 0.437 | 0.218 | 0.625 | 0.312 | 0.437 | 0.312 | 0.060 | 0.625 | CHV-0807Z1 | 2021796 | 1.91 | 100 |
| | 0.281 | 0.625 | 0.312 | 0.437 | 0.312 | 0.060 | 0.625 | CHV-0809Z1 | 2021797 | 1.86 | 100 |
| | 0.343 | 0.687 | 0.375 | 0.437 | 0.312 | 0.060 | 0.625 | CHV-0811Z1 | 1857503 | 1.99 | 100 |
| | 0.406 | 0.687 | 0.375 | 0.437 | 0.312 | 0.060 | 0.750 | CHV-0813Z1 | 1993902 | 2.53 | 100 |
| 0.500 | 0.218 | 0.687 | 0.312 | 0.500 | 0.343 | 0.060 | 0.625 | CHV-0907Z1 | 2021798 | 2.08 | 100 |
| | 0.281 | 0.687 | 0.312 | 0.500 | 0.343 | 0.060 | 0.625 | CHV-0909Z1 | 2021799 | 2.07 | 100 |
| | 0.343 | 0.750 | 0.375 | 0.500 | 0.343 | 0.060 | 0.625 | CHV-0911Z1 | 2021800 | 2.15 | 100 |
| | 0.406 | 0.750 | 0.375 | 0.500 | 0.343 | 0.060 | 0.750 | CHV-0913Z1 | 1857508 | 2.53 | 100 |
| 0.562 | 0.218 | 0.750 | 0.312 | 0.562 | 0.437 | 0.060 | 0.625 | CHV-1007Z1 | 1857509 | 2.28 | 100 |
| | 0.281 | 0.750 | 0.312 | 0.562 | 0.437 | 0.060 | 0.625 | CHV-1009Z1 | 2021801 | 2.24 | 100 |
| | 0.343 | 0.812 | 0.375 | 0.562 | 0.437 | 0.060 | 0.625 | CHV-1011Z1 | 2021802 | 2.39 | 100 |
| | 0.406 | 0.812 | 0.375 | 0.562 | 0.437 | 0.060 | 0.750 | CHV-1013Z1 | 2021803 | 2.81 | 100 |

Actual part weights are for reference only and may vary from weights shown.
 Reference numbers provided as a reference only and do not correspond to part quantities.

Half Clips KMC

Hot Dipped Galvanized Steel, Chem-Treated G90 Finish, per ASTM A653/A653M, 1/32" Thick Black Vinyl Cushion



Half clips are used primarily for holding wires, tubing, conduit, or pipe against a solid backing surface. For this purpose it is excellent and easy to assemble.

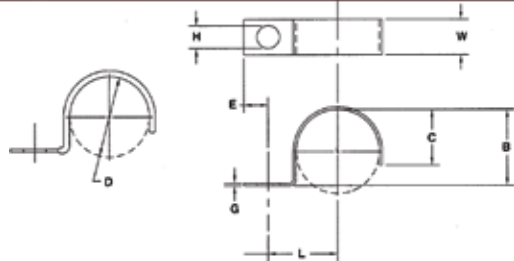

| D | H | L | E | B | C | G | W | | | | |
|----------------------------|--------------------|---------------------------|----------------------|---------------------------------|------------------|---------------|----------------|-----------------|-------------|-------------------|----------|
| Clamping Diameter ±.031 | Hole Dia. ±.005 | Center To Center ±.031 | Hole To End ±.015 | Base To Top Of Dia. ±.015 | Closure ±.015 | Gage ±.002 | Width ±.020 | KMC Part Number | Part Number | Lbs. Per 100 Pcs. | Quantity |
| 0.625 | 0.218 | 0.812 | 0.312 | 0.625 | 0.406 | 0.060 | 0.625 | CHV-1107Z1 | 2021804 | 2.41 | 100 |
| | 0.281 | 0.812 | 0.312 | 0.625 | 0.406 | 0.060 | 0.625 | CHV-1109Z1 | 2021805 | 2.37 | 100 |
| | 0.343 | 0.875 | 0.375 | 0.625 | 0.406 | 0.060 | 0.625 | CHV-1111Z1 | 2021806 | 2.47 | 100 |
| | 0.406 | 0.875 | 0.375 | 0.625 | 0.406 | 0.060 | 0.750 | CHV-1113Z1 | 2021807 | 2.92 | 100 |
| 0.687 | 0.218 | 0.812 | 0.312 | 0.687 | 0.437 | 0.060 | 0.625 | CHV-1207Z1 | 2021808 | 2.62 | 100 |
| | 0.281 | 0.812 | 0.312 | 0.687 | 0.437 | 0.060 | 0.625 | CHV-1209Z1 | 2021809 | 2.56 | 100 |
| | 0.343 | 0.875 | 0.375 | 0.687 | 0.437 | 0.060 | 0.625 | CHV-1211Z1 | 2021810 | 2.66 | 100 |
| | 0.406 | 0.875 | 0.375 | 0.687 | 0.437 | 0.060 | 0.750 | CHV-1213Z1 | 2021811 | 2.75 | 100 |
| 0.750 | 0.218 | 0.875 | 0.312 | 0.750 | 0.468 | 0.060 | 0.625 | CHV-1307Z1 | 2021812 | 2.84 | 100 |
| | 0.281 | 0.875 | 0.312 | 0.750 | 0.468 | 0.060 | 0.625 | CHV-1309Z1 | 1857522 | 2.71 | 100 |
| | 0.343 | 0.937 | 0.375 | 0.750 | 0.468 | 0.060 | 0.625 | CHV-1311Z1 | 2021813 | 2.83 | 100 |
| | 0.406 | 0.937 | 0.375 | 0.750 | 0.468 | 0.060 | 0.750 | CHV-1313Z1 | 2021814 | 3.34 | 100 |
| 0.812 | 0.281 | 0.937 | 0.375 | 0.812 | 0.531 | 0.060 | 0.750 | CHV-1409Z1 | 2021815 | 3.61 | 100 |
| | 0.343 | 0.937 | 0.375 | 0.812 | 0.531 | 0.060 | 0.750 | CHV-1411Z1 | 2021816 | 3.56 | 100 |
| | 0.406 | 0.937 | 0.375 | 0.812 | 0.531 | 0.060 | 0.750 | CHV-1413Z1 | 2021817 | 4.17 | 100 |
| 0.875 | 0.281 | 0.968 | 0.437 | 0.812 | 0.593 | 0.060 | 0.750 | CHV-1509Z1 | 2021818 | 3.94 | 100 |
| | 0.343 | 0.968 | 0.437 | 0.812 | 0.593 | 0.060 | 0.750 | CHV-1511Z1 | 2021819 | 3.89 | 100 |
| | 0.406 | 0.968 | 0.437 | 0.812 | 0.593 | 0.060 | 0.750 | CHV-1513Z1 | 2021820 | 4.55 | 100 |
| 0.937 | 0.281 | 1.000 | 0.437 | 0.937 | 0.625 | 0.060 | 0.750 | CHV-1609Z1 | 2021821 | 4.25 | 100 |
| | 0.343 | 1.000 | 0.437 | 0.937 | 0.625 | 0.060 | 0.750 | CHV-1611Z1 | 2021822 | 4.20 | 100 |
| | 0.406 | 1.000 | 0.437 | 0.937 | 0.625 | 0.060 | 0.750 | CHV-1613Z1 | 2021823 | 4.91 | 100 |
| 1.000 | 0.281 | 1.062 | 0.437 | 1.000 | 0.687 | 0.060 | 0.750 | CHV-1709Z1 | 2021824 | 4.51 | 100 |
| | 0.343 | 1.062 | 0.437 | 1.000 | 0.687 | 0.060 | 0.750 | CHV-1711Z1 | 2021825 | 4.49 | 100 |
| | 0.406 | 1.062 | 0.437 | 1.000 | 0.687 | 0.060 | 0.750 | CHV-1713Z1 | 2021826 | 5.30 | 100 |

Actual part weights are for reference only and may vary from weights shown. Reference numbers provided as a reference only and do not correspond to part quantities.